

Passport Card

The Passport Card is NOT FOR TRAVEL BY AIR.

The Passport Card can ONLY be used for land and sea travel between the United States, Canada, Mexico, Bermuda, and the Caribbean.

**** SUBMIT A PHOTOCOPY OF THE IDENTIFICATION DOCUMENT PRESENTED. ****

- 1) The photocopy must be of the ID document that you will present when you apply.
- 2) Photocopy must be on plain white, 8 1/2 x 11" standard paper.
- 3) The paper should be free of other images and/or markings.

ALL PASSPORT FEES SUBJECT TO CHANGE.

**FOR CURRENT FEE INFORMATION PLEASE CALL OUR OFFICE AT:
(281) 341-4517**

or visit:

www.fortbendcountytexas.gov

Office of Annie Rebecca Elliott
Fort Bend County District Clerk
1422 Eugene Heimann Circle, Rm 10142
Justice Center
Richmond, Texas 77469

Thank you.

Revised 01/23/2017

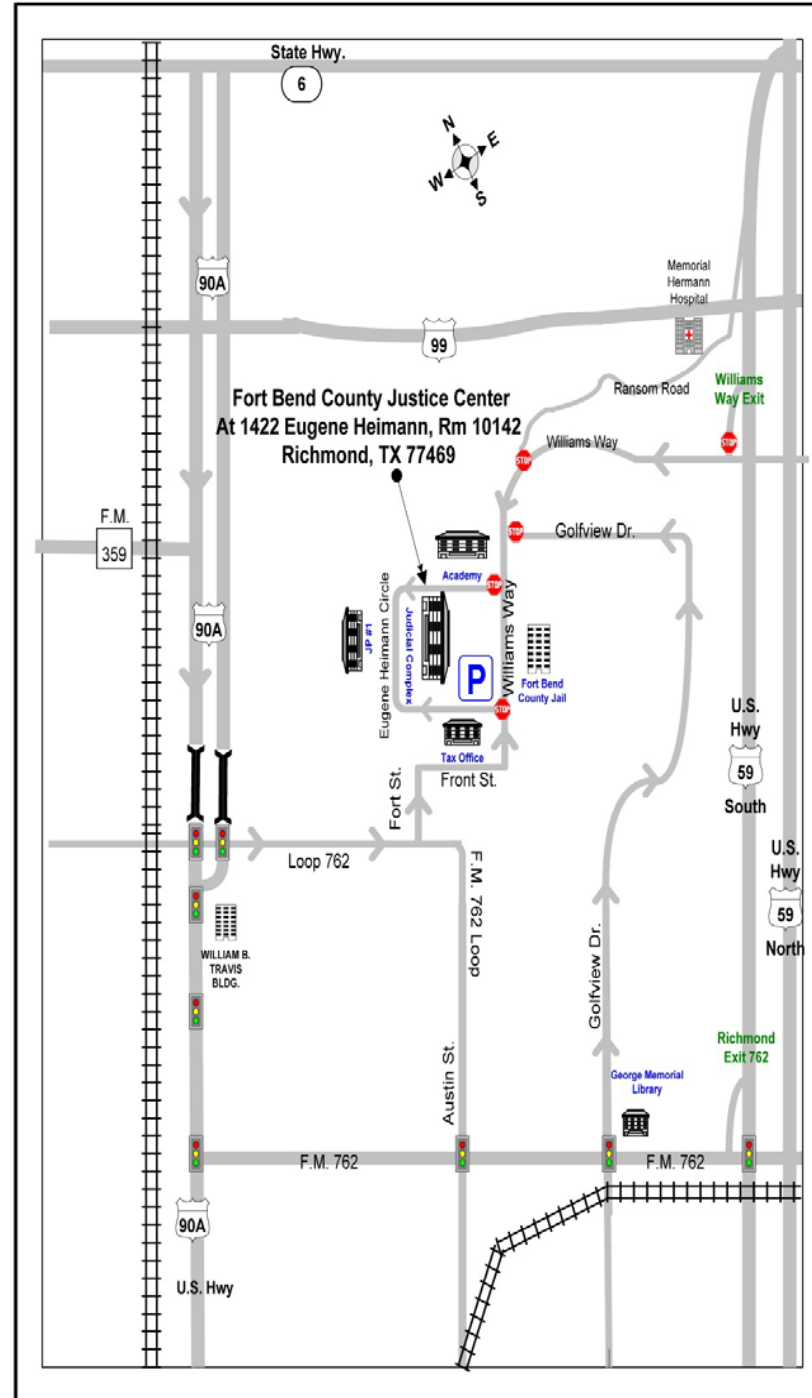

Fort Bend County District Clerk Passport Acceptance Facility



Annie Rebecca Elliott
District Clerk
281-341-4517

Adult (Age 16 and older)

ALL APPLICANTS MUST BE PRESENT

Note: Applicants age 16 & 17 must have
(1) parent present

CHECK OR MONEY ORDER PAYABLE TO THE:

U.S. DEPARTMENT OF STATE

(NO CASH OR CREDIT CARDS ACCEPTED)

***PASSPORT CARD ONLY:**

Routine Service:.....\$30.00
Expedited Service:.....\$90.00

***PASSPORT BOOK ONLY:**

Routine Service:.....\$110.00
Routine Service plus Express Mail:.....\$125.45
Expedited Service:.....\$170.00
Expedited plus Express Mail:.....\$185.45

***PASSPORT BOOK AND *PASSPORT CARD:**

Routine Service:.....\$140.00
Expedited Service:.....\$200.00
Expedited plus Express Mail:.....\$215.45

***CHILDREN (Age 15 and under)**

ALL APPLICANTS MUST BE PRESENT

*ALL MINORS UNDER 16 YEARS OF AGE MUST HAVE **BOTH PARENTS PRESENT** OR **ONE PARENT AND A NOTARIZED CONSENT LETTER OR DS-3053 FORM FROM THE ABSENT PARENT** ****ALONG WITH A COPY OF HIS/HER IDENTIFICATION - FRONT AND BACK****

CHECK OR MONEY ORDER PAYABLE TO THE:

U.S. DEPARTMENT OF STATE

(NO CASH OR CREDIT CARDS ACCEPTED)

*** PASSPORT CARD ONLY:**

Routine Service:.....\$15.00
Expedited Service:\$75.00

*** PASSPORT BOOK ONLY:**

Routine Service:.....\$80.00
Routine Service plus Express Mail:.....\$95.45
Expedited Service:.....\$140.00
Expedited plus Express Mail:.....\$155.45

PASSPORT BOOK AND *PASSPORT CARD:

Routine Service:.....\$95.00
Expedite Service:\$155.00
Expedite plus Express Mail:.....\$170.45

PLEASE HAVE THE FOLLOWING FOR EACH APPLICANT:

Instructions for Passport Execution at our Facility Only

- **Completed DS-11 Application** - (Sections 1-21 Only)
- **Proof of U.S. Citizenship:**
 - For Adults (16 and older) Certified copy of *U.S. Birth Certificate or *Naturalization / *Citizenship Certificate, *Consular Report of Birth Abroad ***(Original and Photocopy Required)** Or Previous Passport.
 - *For Children (15 and under) with a previous valid Passport must have BOTH a certified copy of Birth Certificate and previous passport.

*** Submit a photocopy of the ID document (front and back) that you will present when you apply.**

*As a service we provide copies at \$1.00 per page.

*** 1 Passport Photos** Photos are not taken at this Acceptance Facility**

*** \$25.00 Execution fee:**

*Payable to:

FORT BEND COUNTY DISTRICT CLERK
(ANY TYPE OF PAYMENT ACCEPTED)

NOTE: There is a convenience fee for Credit card payments.

PASSPORT FEE:

* Payable by:

CHECK OR MONEY ORDER ONLY

(Separate check/money order for each applicant)

* Payable to:

U.S. DEPARTMENT OF STATE